



Lean

Lean is a departure from the traditional picture frame mirror. It provides full length visuals, reflecting any image head to toe. It floats off the floor and rests gracefully against the wall at a 5 degree angle. At the same time, the noticeable separation from the wall gives the Lean grace and presence.

The Lean is simple in form, yet its appeal is in the details. The mirrored surface contrasts with the thick wood panel it is affixed to. The lip at the base of the frame that holds the mirror in place is the same depth as the glass, making for a sleek, seamless unified surface.

Lean is available as a wide and narrow mirror in a variety of wood veneers.

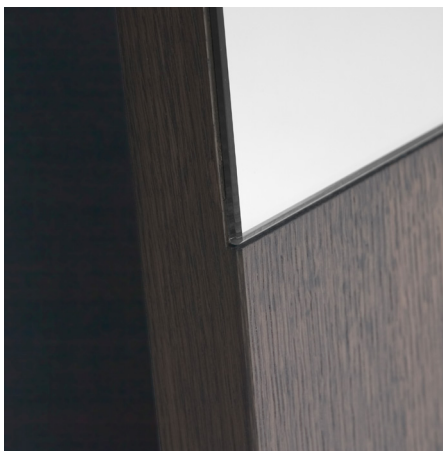

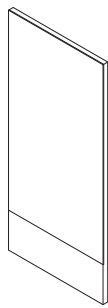

Lean Wide LEAN
L 83cm D 4cm H 183cm / L 32¼" D 1½" H 72"



Lean Narrow LEANN
L 60cm D 4cm H 213cm / L 23½" D 1½" H 84"

Walnut / White Oak / Grey Oak / Wenge

**BEN
SEN**

The Lean mirrors are a combination of core panel construction and veneers. This construction ensures increased structural stability with low weight through a process of heat fusion of panels to substrate for a permanent bond.

The edge grain of the wood follows the direction of the panels. The clear lacquer coat protects the veneer from daily use, while bringing out the natural colours and patterns of select species. The 5 mm thick mirrored glass has polished edges and is carefully bonded to the structural frame.

The Lean sits on inset rubber feet that protect the frame from the floor. Each mirror includes a wall mount safety bracket, which securely holds the mirror to the wall.