

REVISED 9/12/18



#### PRODUCT

JAX CHANDELIER  
JAX 15-002

#### MATERIALS (FINISHES)

ANODIZED ALUMINUM (AGED  
BRONZE, GOLDEN BRONZE, BLACK,  
SILVER)

SOLID OPTIC CRYSTAL (CLEAR,  
FROSTED, SMOKE)

#### WEIGHT

7.3 LBS

#### LAMPING

INTEGRATED LED (QTY 15)  
1.3W, 3000K  
ELV AND PHASE DIMMABLE

#### CERTIFICATIONS

ETL LISTED (120V)

#### NOTES

JAX IS COMPRISED OF MODULAR  
COMPONENTS AND IS MEANT TO  
BE ASSEMBLED ON-SITE BY A  
QUALIFIED ELECTRICIAN AND  
INSTALLATION PROFESSIONAL.

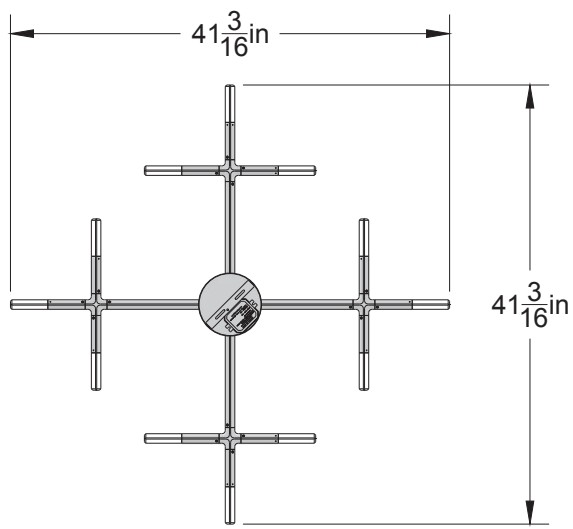

TOP VIEW

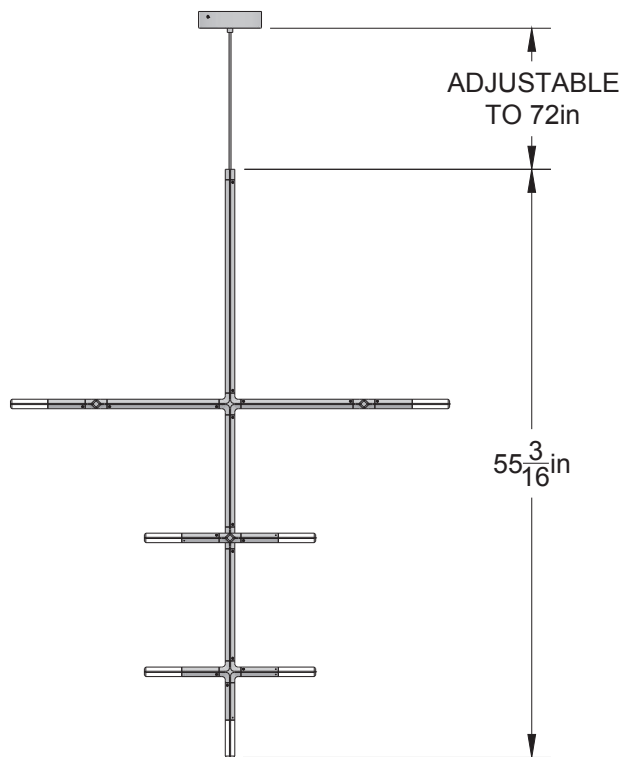

FRONT VIEW

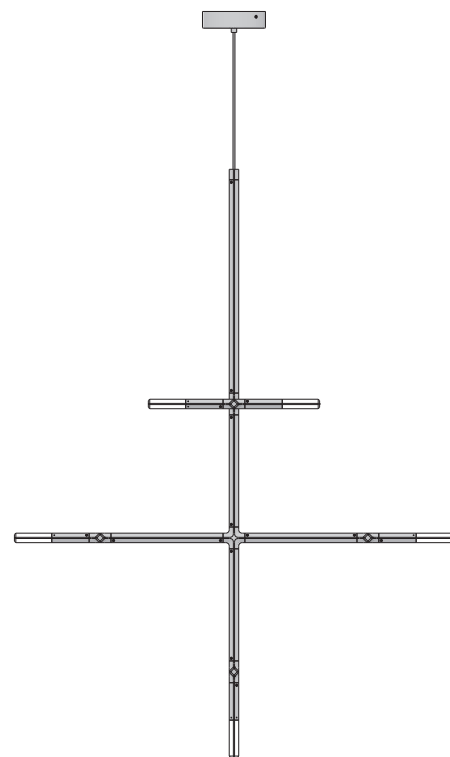

SIDE VIEW

© 2018, LAKE AND WELLS, LLC ALL RIGHTS RESERVED