

## HUTCHISON



**type:** suspension

**materials:** powder coated aluminum body  
PMMA lens  
polyester wire

**wire length:** 108" / 275 cm

<b>weight:</b>	<b>HUT01</b> 1.7 lb/ 0.8 kg	<b>HUT02</b> 3.4 lb/ 1.6 kg	<b>HUT03</b> 5.1 lb/ 2.4 kg	<b>HUT04</b> 6.8 lb/ 3.2 kg
<b>light source:</b>	8W Initial 700 lumen	16W Initial 1400 lumen	24W Initial 2100 lumen	32W Initial 2800 lumen

Dim to warm  
50 000 H  
CRI ≥90  
2 years warranty  
3 SDCM consistency  
IP20

**voltage:** (120-277V / 220-240V)

**dimmer:** refer to our recommended list of dimmer models

**certifications:**    **IP20**

**notes:**

- must be installed by an electrician
- LED may only be changed by Lambert & Fils or other authorized personnel
- additional charges for modifications or for special orders
- dimensions are approximate and may vary slightly

## HUTCHISON 01

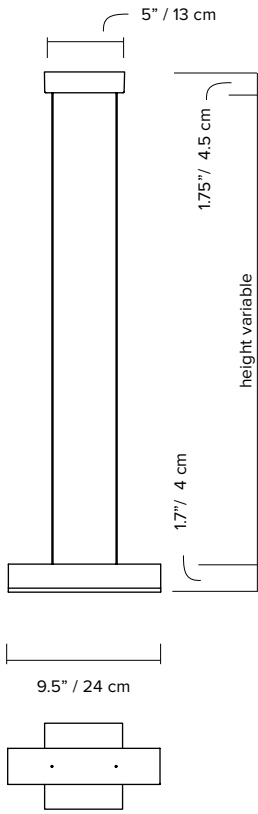

## HUTCHISON 02

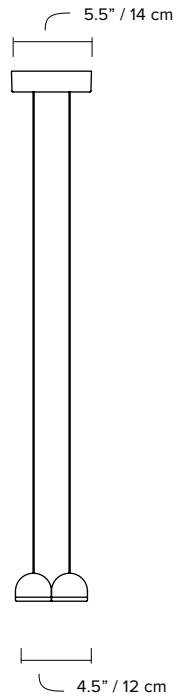
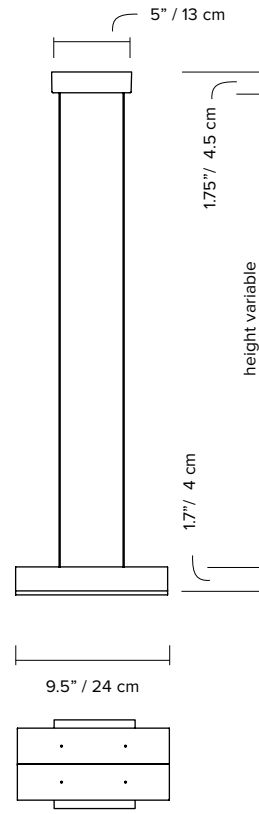

## HUTCHISON 03

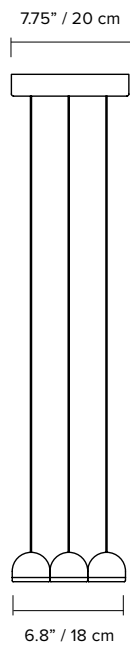
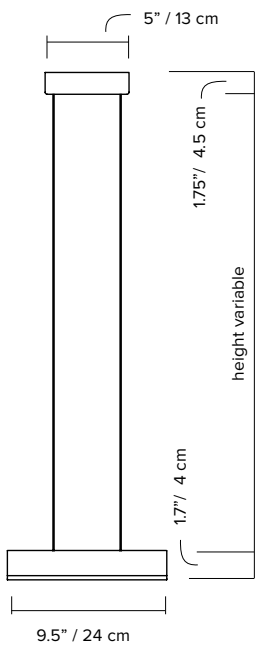

## HUTCHISON 04

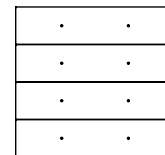
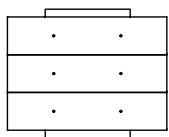
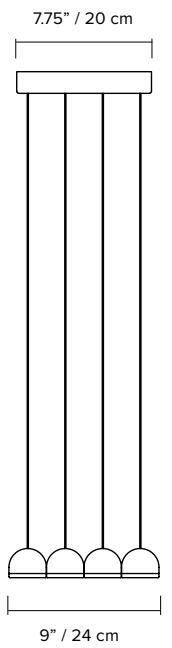
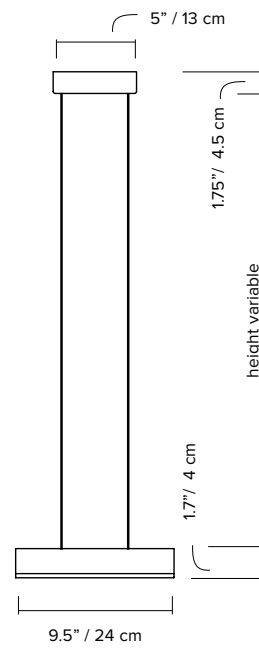

## ORDER GUIDE: SKU

COLLECTION	MODEL	BODY	WIRE	CANOPY
HUT hutchison	01	BL black	BL black	BL black
	02	WH white	WH white	WH white
	03	TC terracotta		TC terracotta
	04	AL aluminum		
HUT	01	BL	BL	BL = HUT01BLBLBL <i>example</i>

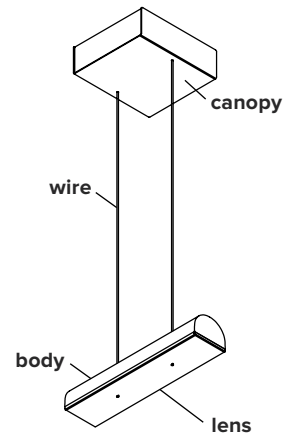

### BODY

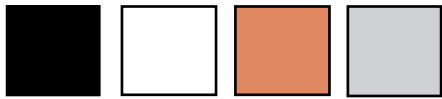

textured black    textured white    flat terracotta    polished aluminum

### WIRE



black    white

### CANOPY

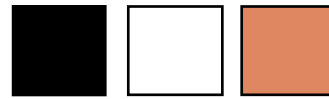

textured black    textured white    flat terracotta

### CANOPIES

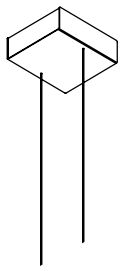

Hutchison 01

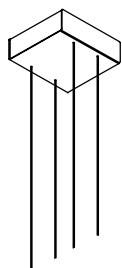

Hutchison 02

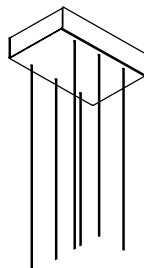

Hutchison 03

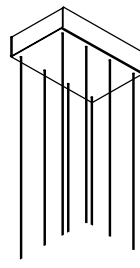

Hutchison 04

## DIMMER SPECIFICATIONS

### TESTED DIMMER LIST COMPATIBILITY - 120V

Compatible with 0-10V, ELV, Phase dimming

Dimmer Brand	Dimmer Model	L&F Model	Max level	Min level
Lutron	TGCL-153P	HUT04	98%	9%
Leviton	VPE06	HUT01-04	98-100%	9-14%
Lutron	DVELV303P	HUT01-04	98-100%	5-11%
Lutron	SELV300P	HUT01-04	98-100%	6-11%
Lightolier	ZP260QEW	HUT01-04	98-100%	8-11%
Lutron	FAELV500	HUT01-04	99-100%	12-17%
Lutron	MAELV600	HUT01-04	98-100%	11-18%
Leviton	IPE04	HUT01-03	100%	4-8%

### TESTED DIMMER LIST COMPATIBILITY - 230V

Compatible with 1-10V, ELV, Phase dimming

Dimmer Brand	Model	L&F Model	Max level	Min level
Clipsal	32E450UDM	HUT01	100%	23%
		HUT02	100%	22%
		HUT04	100%	31%
Clipsal	32E450TM	HUT01	100%	19%
		HUT02	100%	17%
		HUT04	100%	25%
Clipsal	GREEN	HUT03	100%	18%
Clipsal	TRANSPARENT	HUT03	99%	30%

\*Other dimmers can yield good results and we recommend conducting your own test before final installation

## EU ENERGY LABEL

